

THE CLAPPER[®]

THE ORIGINAL HOME AUTOMATION

CLAP ON! CLAP OFF! Sound Activated ON/OFF switch!



Joseph Enterprises, Inc.
Hillside, NJ 07205

THE CLAPPER®

THE ORIGINAL HOME AUTOMATION

Congratulations! You are now the owner of The Clapper. The Clapper is a sound activated on and off switch for appliances. The Clapper can operate either one or two appliances by clapping two times to operate the first appliance and three times to operate the second appliance. The Clapper can also serve as a limited function security device. While in the *AWAY* mode, almost any noise will turn on the connected appliance(s) to discourage potential intruders. The *AWAY* mode is also convenient for temporarily turning on a light when entering a dark room such as a garage or basement. No need to clap, any noise will turn on the lights!

For **QUICK INSTRUCTIONS** on operating your Clapper, please refer to the yellow Quick Tips card. The following are more detailed instructions on how to properly use your Clapper.

FEATURES:

This model is equipped with three special features: Clap Detection Lights, Auto Sound Sensitivity and the Away Mode.

THE CLAPPER[®] DIAGRAM

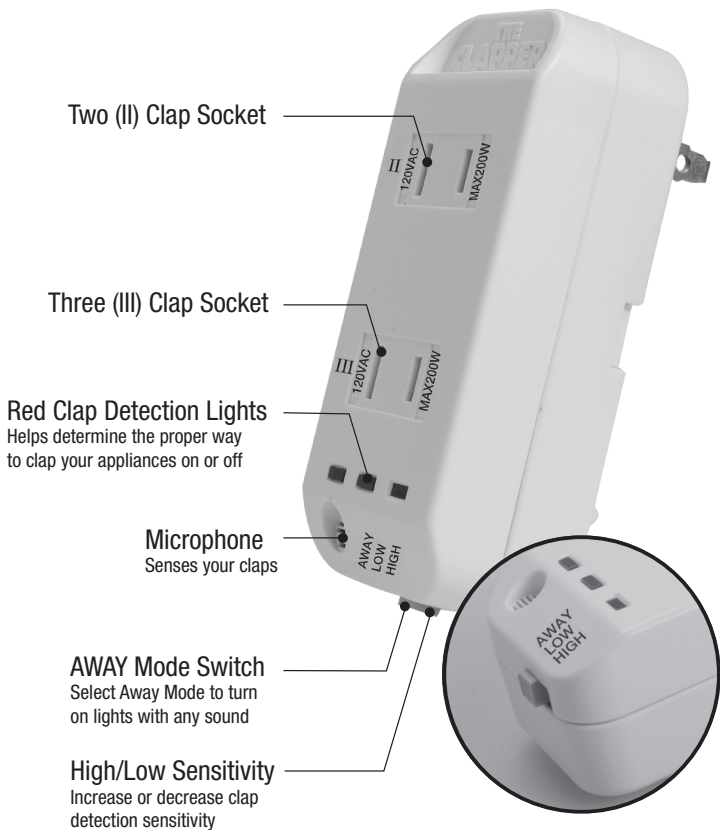

HOW TO OPERATE AN APPLIANCE WITH 2 CLAPS:

1. Set the three position switch on the bottom of the unit to the HIGH position.
2. Plug an appliance into the top receptacle of The Clapper. This is the receptacle next to the “II.”
3. Plug The Clapper into the wall socket.
4. Manually turn your appliance's switch to the "on" position. (It is okay if your appliance does not activate, go on to step 5)
5. You can now turn your appliance on or off by clapping. You don't have to clap very hard! The clapping sequence is more important than how loudly you clap.

CLAP (pause) CLAP (pause) (pause) (pause)

where each pause is approximately ½ second long. Be sure to pause after the second clap. If the Clapper detects a third clap before the appliance turns on, the appliance connected to the II clap receptacle will not activate. The Clapper will also not activate your appliance if you are clapping too slow. If you are having difficulty, try clapping a bit faster using the clap detection lights described on page 6.

HOW TO OPERATE AN APPLIANCE WITH 3 CLAPS:

1. Set the three position switch on the side of the unit to

the HIGH position.

2. Plug an appliance into bottom receptacle of The Clapper.

3. Plug The Clapper into the wall socket.

4. Manually turn your appliance's switch to the "on" position. (It is okay if your appliance does not activate, go on to step 5)

5. You can now turn your appliance on or off by clapping. You don't have to clap very hard. The clapping sequence is more important than how loudly you clap:

CLAP (pause) CLAP (pause) CLAP (pause) (pause) (pause)

where each pause is approximately $\frac{1}{2}$ second long. Be sure to pause after the third clap. If the Clapper detects another sound after the third clap but before the appliance turns on, the appliance will not activate. The Clapper will also not activate your appliance if you are clapping too slow. If you are having difficulty, try clapping a bit faster using the clap detection lights described below.

CLAP DETECTION LIGHTS

Use the three red lights on the face of The Clapper to help you determine the proper way to clap your appliances on or off. A clap detection light will glow when a proper clap (or similar sound) is detected.

When the Clapper detects the first clap (or similar sound) the far left light will glow. When clapping a second time,

the middle light should glow right next to the far left light. As long as the Clapper does not detect any other sounds, it will activate the appliance attached to the "II Clap socket." If a third clap is detected, then the third and final light will glow and the appliance connected to the "III Clap socket" will activate.

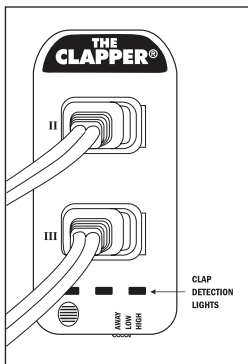

If you clap and the far left and the far right lights glow with the middle light staying dark, it means the clapper does not recognize your claps and will not activate the appliance. This can happen when your claps are too soft, too slow, or too fast for the Clapper to register.

AUTO SOUND SENSITIVITY:

If room noise is detected or if the 2 clap or 3 clap sequences are not proper, the Clapper will reject the sounds as noise. It indicates that it has rejected the noise by turning the LEFT and RIGHT clap detection lights on and automatically reduces the sensitivity of the Clap detection. This feature of automatically reducing the clap detection sensitivity helps to reduce background noises from turning on the appliances. The LEFT and RIGHT lights will remain on until the

background noise is not detected. You can still clap while the lights are on, but because of the background noise you will need to clap louder. When all of the red lights go off the sensitivity of the Clapper Clap detection is at its greatest.

You may notice the lights glowing occasionally even if you have not clapped. This is not unusual as The Clapper has detected sounds that are similar to a clap. Your appliances should not activate as it would require a second or third sound similar to a clap within the proper time allowed.

By observing the clap detection lights you can become familiar with the types of claps (or similar sounds) that will activate your appliances attached to The Clapper.

MANUAL SOUND SENSITIVITY

You can also manually adjust your Clapper to respond to soft or loud claps, as well as adjust for the noise level in your room.

Placing the three position switch on the side of The Clapper to the HIGH position puts The Clapper in the high sensitivity mode. This is helpful if your claps are soft or if The Clapper is far away. Your appliance, however, may occasionally turn on or off unexpectedly as The Clapper may detect other noises similar to your claps.

Sliding the switch down to LOW will put The Clapper

into the low sensitivity mode. This is helpful if there is a lot of external noise in the room that may falsely activate your appliances. By adjusting the three position mode switch to the high or low sensitivity, you will be able to activate your appliances easily and, with less false activation due to external noises. Sliding the switch all the way down to the AWAY position will put The Clapper in the AWAY mode (See next page).

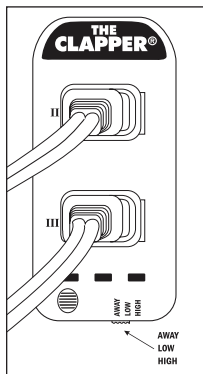

For use in very noisy environments the Clapper has a third sensitivity level. To activate this sensitivity level:

1. Put the HIGH –AWAY slide switch into the AWAY position.
2. Slide the switch from AWAY to HIGH back to AWAY three(3) times.
3. All 3 red lights will now be on. They will remain on for about 10 seconds and then turn off. Now The Clapper is in the very low sensitivity mode.
4. To return to regular operations just move the slide switch out of the AWAY position.

THE AWAY SETTING

The Clapper can also serve as a limited function security device. While in the “AWAY” mode, almost any noise will turn on the connected appliance(s) to discourage potential intruders.

The AWAY mode is also convenient for temporarily turning on a light when entering a dark room such as a garage or basement. No need to clap, any noise will turn on the lights!

To operate The Clapper in the AWAY mode

1. Slide the three position switch down to the AWAY position.
2. Both lamps will turn on. This allows you to leave the room with the lights on. After 10 seconds without hearing a noise, both lamps will turn off.
3. The Left Red clap detection light will blink to indicate The Clapper is in the Away Mode.
4. If a sound is heard your lamp(s) will turn on and They will remain on for about 10 minutes and then turn off. Then the Clapper, resets itself until the next sound is detected.

Hints and Tips

If The Clapper does not turn on when clapping:

- a. Make sure The Clapper is plugged in properly. When The Clapper is first plugged in, the red lights on the front of

the Clapper will sequence through a start-up pattern. Wait for these lights to stop flashing before you start to clap. If the red lights do not light up at all, your Clapper is no longer functional.

- b. Make sure the Appliance is plugged into the Clap II or Clap III socket.
- c. Make sure the appliance's switch is in the "on" position.
- d. Make sure the claps are loud enough and have the correct timing. Use the indicator lights to determine if the Clapper is registering your claps. See pages 4 and 5 for the timing of the claps and indicator light usage.

FAQ

1. Which appliances does the Clapper work with?

- a. Christmas Tree lights
 - Yes that is a good use of the product.
- b. Fluorescent lights
 - Yes
- c. LED Light Bulbs
 - Yes
- d. Normal (Incandescent) lights
 - Yes
- e. A TV
 - It is possible, but most of today's TVs need to remain plugged in to keep their settings and

work with the remote control.

f. A radio

- Yes, but be aware that some of the today's radios require that they be plugged in all of the time or do not turn on when power is applied. Those will not work.

g. A three-way light bulb

- Yes, set the light to one of the three brightness levels, then the Clapper is used to turn on and off the light.

h. A desk fan

- Yes, as long as it is below 200 watts and will turn on automatically when power is applied.

2. Which appliances should I NOT use with the Clapper?

WARNING: Do not plug in to anything above 200 watts, here are some examples.

a. Any electrical heating appliance

1. Coffee maker
2. space heater
3. Toasters
4. Etc.

b. Medical equipment

c. Inductive loads, such as a motor

d. An Air Conditioner

- An Air Conditioner is higher than the maximum allowed wattage of 200 watts

e. A Computer monitor

- Most computer monitors do not turn on when the power is applied so this is not a good application for the Clapper
- f. Do not plug The Clapper into any non-standard power source such as a dimming circuit.

3. Does the Clapper have two or three prong sockets?

- a. Two prong

4. What is the Maximum wattage that the Clapper can control?

- a. 200 watts per outlet. Do not exceed a total of 400 watts.

5. Does the Clapper work overseas on 220 volts?

- a. No, the Clapper is designed only for 120 vac.

6. Can I control two lights at the same time?

- a. Yes. The Clapper has two sockets, the top socket is controlled by clapping two times and the bottom socket by clapping three times.

7. My Clapper is not working anymore why?

- a. The Clapper is made with a fuse for safety reasons
 - If the Clapper is over loaded with too high of wattage the Clapper fuse will blow and the Clapper will not work. The fuse is not replaceable be the user.

8. How close do I need to be to the Clapper for it to hear my claps?

This depends greatly on the room and the objects between you and the Clapper.

1. First do not block the Clapper with drapes or furniture. These will block your claps from reaching the Clapper.
2. Familiarize yourself with how the Clapper works in your room by:
 - a. Standing within about 5 feet of the Clapper and clap to turn on/off the light.
 - b. Move back a few feet and try again.
 - c. Continue until you are too far away from the Clapper for it to detect your claps.
3. Now you know the clap detection range in your room.

9. There are three red LED lights on the front of the Clapper what are they for?

a. The three Red lights on the face of the Clapper are the CLAP DETECTION LIGHTS. These will help you determine the proper way to clap your appliances on or off.

1. Each clap detection light will glow when a proper clap (or similar sound) is detected. Claps that are too soft will not be detected. Claps that are too fast or too slow will be rejected as noise and as a result the appliance will not activate. When the Clapper detects the first clap (or similar sound) the first light will glow. The second light will glow

if a second clap is detected about $\frac{1}{2}$ second after the first clap occurs. If the Clapper does not detect a third clap, it will have activated the appliance attached to the “II Clap socket.” If a third clap is detected, then the third light will glow and the appliance connected to the “III Clap Socket” will activate.

10. The Clapper turned on or off the lights when I was not expecting it too, what can I do?

- a. Change the Sensitivity switch setting from Hi to Low.
- b. Or use the three clap socket. The three clap socket is less likely to turn on or off by random noises.

11. What is the “Away” setting used for?

- a. The Clapper can also serve as a limited function security device. While in the “AWAY” mode, almost any noise will turn on the connected appliance(s) to discourage potential intruders.
- b. The AWAY mode is also convenient for temporarily turning on a light when entering a dark room such as a garage or basement. No need to clap, any noise will turn on the lights!

IMPORTANT SAFETY NOTES

1. **CAUTION:** Risk of Electric Shock and Fire Hazard
2. For adult use only. This is not a toy. This is not intended

for use by children.

3. Match wide blade of plug to wide slot, fully insert. For safe use, plug only into exposed wall outlets where a device is ventilated and cannot contact bed covering or other material.
4. Do not use The Clapper with any electrical heating appliances such as toasters, hair dryers, coffee pots, etc.
5. Do not use The Clapper with any appliance that can create a fire hazard with prolonged use.
6. The maximum wattage for an appliance is 200 watts in either outlet. Do not exceed 400 watts total. 200/400 watts, (3.3 Amps.) 120 VAC, 50/60 Hz. General Purpose, Tungsten Electronic Ballast.
7. Do not use with medical equipment.
8. Do not use with inductive loads.
9. Indoor Dry Location Use Only

WARNING

The Clapper® requires standard 120 VAC power.

Do not plug The Clapper into any non-standard power source as this may lead to electric shock or fire. For example, **Do Not** use The Clapper on a Dimming circuit.

This device complies with part 15 of the FCC Rules.

Operation is subject to the following two conditions:

1. This device may not cause harmful interference.

2. This device must accept any interference received, including interference that may cause undesired operation.

WE WELCOME YOUR FEEDBACK

*Many questions can be answered by calling our Clapper Hotline at **800-557-5856**.*

*For quick answers to common questions, please refer to our website's FAQ section. If you have further inquiries, email us at **help@chia.com**.*

THIRTY (30) DAY LIMITED WARRANTY

Joseph Enterprises offers a thirty (30) day limited warranty to the original purchaser of The Clapper[®]. The warranty covers defects in workmanship and materials only. It does not apply to product failures resulting from accidental damage, neglect, misuse or any other cause not associated with defects in workmanship or materials.

Should The Clapper[®] prove to be defective within the thirty (30) days from the date of purchase, the product will either be repaired or replaced, at Joseph Enterprises' discretion, free of charge.

To receive warranty service contact us at

customerservice@jeiusa.com for further directions.

Purchasers are advised to carefully read and follow the operating and safety instructions contained in this book and included on the back of the product.

THIS PARTICULAR WARRANTY SHALL DISCLAIM JOSEPH ENTERPRISES' OBLIGATION AND SOLE RESPONSIBILITY RESPECTING THE PRODUCT AND ALL OTHER WARRANTIES, IMPLIED OR EXPRESSED, INCLUDING IMPLIED WARRANTIES OF FITNESS FOR A SPECIFIC PURPOSE. JOSEPH ENTERPRISES DOES NOT AUTHORIZE RETAILERS AND OTHERS TO MAKE ANY WARRANTY CONCERNING THE PRODUCT.

SOME STATES DO NOT PERMIT TIME LIMITATIONS ON AN IMPLIED WARRANTY, OR LIMITATION OR EXCLUSION OF INCIDENTAL OR CONSEQUENTIAL DAMAGES, SO THE ABOVE LIMITATIONS MAY NOT PERTAIN TO YOU. THIS WARRANTY GRANTS YOU SPECIFIC LEGAL RIGHTS AND YOU MAY ALSO HAVE ADDITIONAL RIGHTS THAT VARY FROM STATE TO STATE.

CAUTION:

Indoor Dry Location Use Only

WARNING: Changes or modifications not expressly approved by the party responsible for compliance could void the user's authority to operate the equipment.

NOTE: This equipment has been tested and found to comply with the limits for a Class B digital device, pursuant to part

15 of the FCC Rules. These limits are designed to provide reasonable protection against harmful interference in a residential installation. This equipment generates, uses and can radiate radio frequency energy and, if not installed and used in accordance with the instructions, may cause harmful interference to radio communications. However, there is no guarantee that interference will not occur in a particular installation. If this equipment does cause harmful interference to radio or television reception, which can be determined by turning the equipment off and on, the user is encouraged to try to correct the interference by one or more of the following measures:

- Reorient or relocate the receiving antenna.
 - Increase the separation between the equipment and receiver.
 - Connect the equipment into an outlet on a circuit different from that to which the receiver is connected.
 - Consult the dealer or an experienced radio/TV technician for help.
- This device complies with Part 15 of the FCC Rules. Operation is subject to the following two conditions: (1) this device may not cause harmful interference, and (2) this device must accept any interference received, including interference that may cause undesired operation.

FCC Radiation Exposure Statement

This equipment complies with FCC radiation exposure limit set forth for an uncontrolled environment. This equipment should be installed and operated with minimum distance 20 cm between the radiator & your body.